

Dimensions for Class 900 Flanges

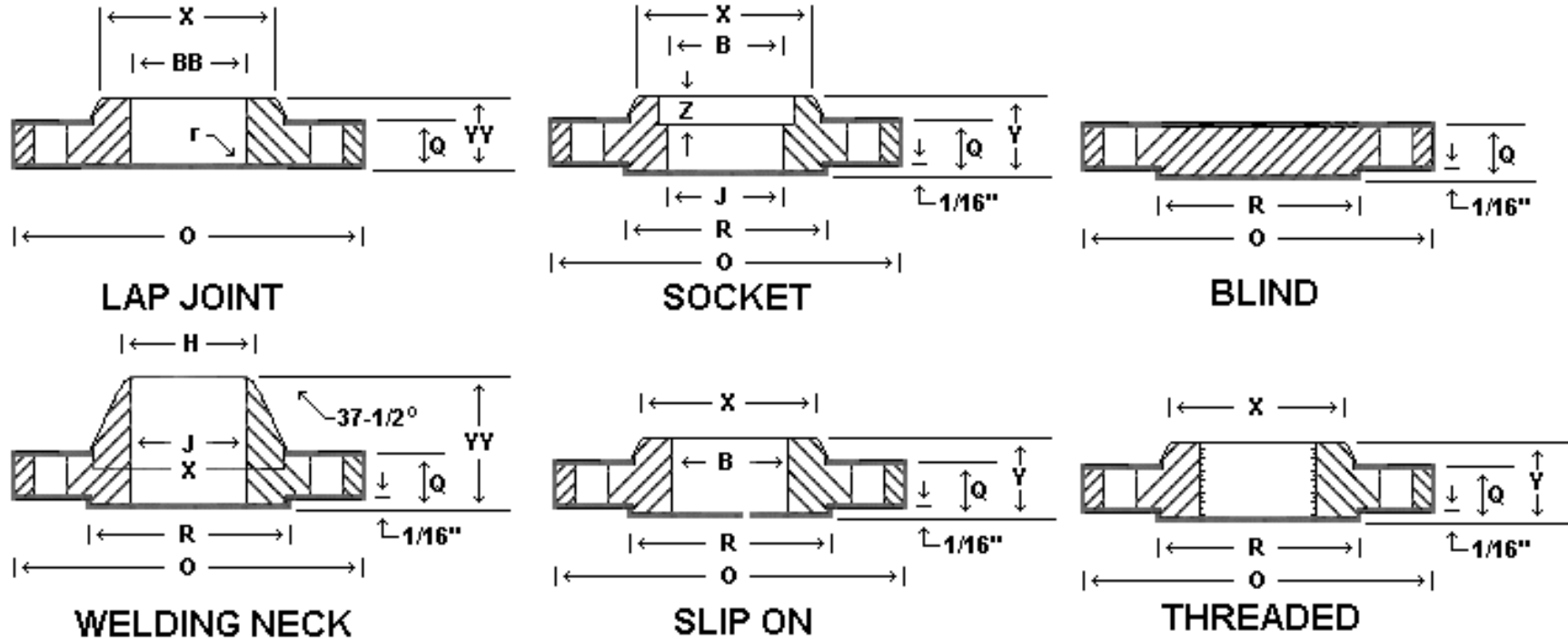

Nom. Pipe Size (inches)	O	Q*	R	X	No. and** Dia of Bolt Holes	Bolt Circle Dia.	YY*	H	J	Y*	B	r	YV	BB	Z	C	T
1/2	4.75	0.88	1.38	1.50	4-0.88	3.25	2.38	0.84		1.25	0.88	0.12	1.25	0.90	0.93	0.88	
3/4	5.12	1.00	1.69	1.75	4-0.88	3.50	2.75	1.05		1.38	1.09	0.12	1.38	1.11	1.14	1.00	
1	5.88	1.12	2.00	2.06	4-1.00	4.00	2.88	1.32		1.62	1.36	0.12	1.62	1.38	1.41	1.12	
1 1/4	6.25	1.12	2.50	2.50	4-1.00	4.38	2.88	1.66		1.62	1.70	0.19	1.62	1.72	1.75	1.19	
1 1/2	7.00	1.25	2.88	2.75	4-1.12	4.88	3.25	1.90		1.75	1.95	0.25	1.75	1.97	1.99	1.25	
2	8.50	1.50	3.62	4.12	8-1.00	6.50	4.00	2.38		2.25	2.44	0.31	2.25	2.46	2.50	1.50	
2 1/2	9.62	1.62	4.12	4.88	8-1.12	7.50	4.12	2.88		2.50	2.94	0.31	2.50	2.97	3.00	1.88	
3	9.50	1.50	5.00	5.00	8-1.00	7.50	4.00	3.50		2.12	3.57	0.38	2.12	3.60	3.63	1.62	
4	11.50	1.75	6.19	6.25	8-1.25	9.25	4.50	4.50		2.75	4.57	0.44	2.75	4.60	4.63	1.88	
5	13.75	2.00	7.31	7.50	8-1.38	11.00	5.00	5.56		3.12	5.66	0.44	3.12	5.69	5.69	2.12	
6	15.00	2.19	8.50	9.25	12-1.25	12.50	5.50	6.63		3.38	6.72	0.50	3.38	6.75	6.75	2.25	

Dimensions for Class 900 Flanges

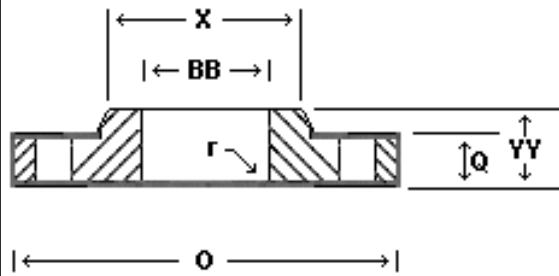

LAP JOINT

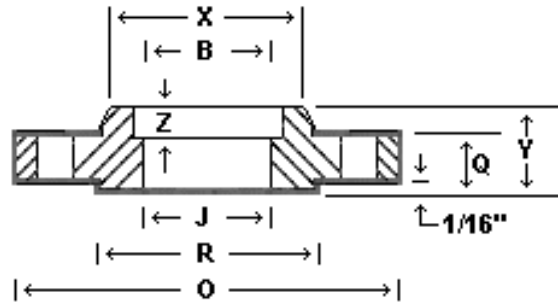

SOCKET

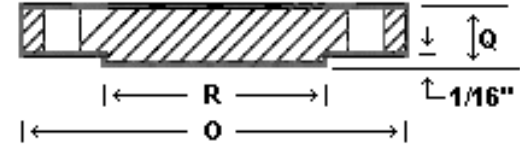

BLIND

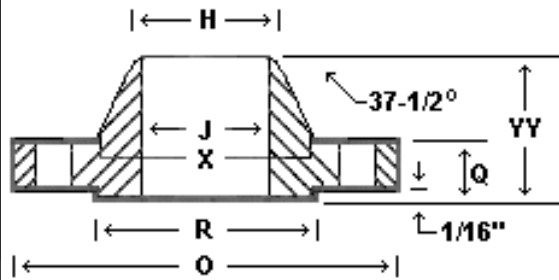

WELDING NECK

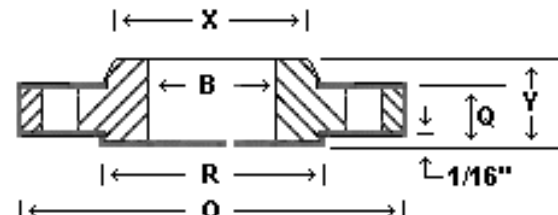

SLIP ON

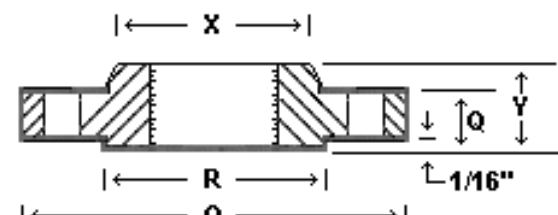

THREADED

Nom. Pipe Size (inches)	O	Q*	R	X	No. and** Dia of Bolt Holes	Bolt Circle Dia.	YY*	H	J	Y*	B	r	YV	BB	Z	C	T
8	18.5	2.50	10.62	11.75	12-1.50	15.5	6.38	8.63	P u r c a s e r	4.00	8.72	0.50	4.5	8.75	8.75	2.50	
10	21.50	2.75	12.75	14.50	16-1.50	18.50	7.25	10.75		4.25	10.88	0.50	5.00	10.92	10.88	2.81	
12	24.00	3.12	15.00	16.50	20-1.50	21.00	7.88	12.75		4.62	12.88	0.50	5.62	12.92	12.94	3.00	
14	25.25	3.38	16.25	17.75	20-1.62	22.00	8.38	14.00		5.12	14.14	0.50	6.12	14.18	14.19	3.25	
16	27.75	3.50	18.50	20.00	20-1.75	24.25	8.5	16.00		5.25	16.16	0.50	6.50	16.19	16.19	3.38	
18	31.00	4.00	21.00	22.25	20-2.00	27.00	9.00	18.00		6.00	18.18	0.50	7.50	18.20	18.19	3.50	
20	33.75	4.25	23.00	24.50	20-2.12	29.50	9.75	20.00		6.25	20.20	0.50	8.25	20.25	20.19	3.62	
24	41.00	5.50	27.25	29.50	20-2.62	35.50	11.50	24.00		8.00	24.25	0.50	10.50	24.25	24.19	4.00	